

About bdi

BDI are an award winning, North West based, structural engineering consultancy. For over a decade BDI have been providing structural engineering solutions for residential projects, working with clients, architects and builders all over the UK. We have a strong commitment to quality and service and are proud that much of our work comes through recommendations and repeat business.



...when do I need an Engineer?

To comply with building regulations you would consult a Structural Engineer on any project that involves a structural alteration. This includes if your project involves removing load-bearing walls or chimney stacks, cutting timbers out of a roof structure, widening doorways or windows, digging basements or lowering floors, building on soft or contaminated ground, or near large trees.

The role of the Structural Engineer is to assess whether a new structure will be safe, or whether an alteration will affect the safety of the existing building. When you are undertaking your project you will require the services of an engineer to provide you with a package of information to satisfy building regulations. Our team of chartered and incorporated Structural Engineers have the necessary professional skills and qualifications to ensure your project is successful.

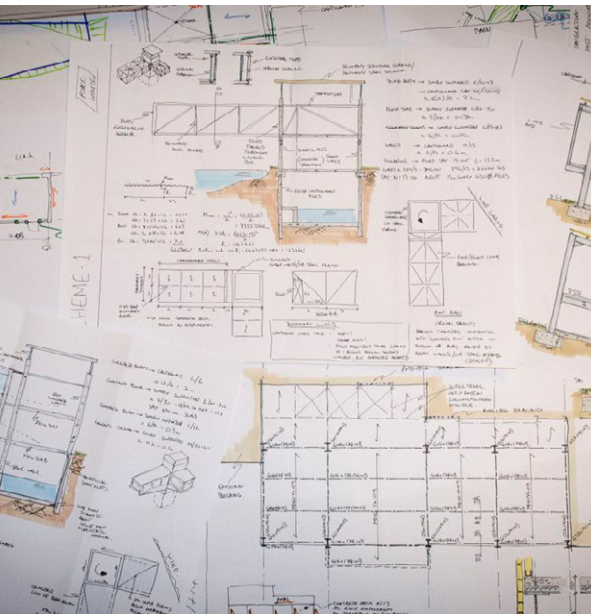

...so what does a Structural Engineer actually do?

A Structural Engineer applies science and maths combined with underlying technical principals to provide solutions. By completing design calculations we can determine the size of individual structural elements such as floor joists, roof timbers, steel beams and columns, timber rafters and foundations. The calculations we complete are in accordance with internationally recognised 'Codes of Practice' including British Standards and Eurocodes. Using our extensive knowledge and experience of how existing buildings were built, we can assess the stability of the existing structures.

We also use our local knowledge of ground conditions and other environmental factors to ensure the structure is going to be suited to its site. Finally a Structural Engineer ensures buildings are built in a way that is robust ensuring no collapse will occur disproportionate to its cause.

...why can't my Architect do that?

An Architect deals with the form and function of the building, and while they will be able to come up with ways of making our structural design fit into the plans, they are unable to assess the safety of the building. Often a Structural Engineer can save you money by providing advice on the most efficient systems or by using their knowledge of the practicalities of construction.

...and what do I actually get?

Our package of information provides a set of clear and concise documents to obtain building regulations, allow a contractor to price and then build your project.

Typically it would include:

- design drawings, outlining our intentions
- detailed design calculations
- designer's risk assessments, showing any residual risks to the contractor to ensure construction is completed safely
- outline method statements, for more complex elements of work



...and if it goes wrong?

Fortunately things rarely go drastically wrong. This is down to the high level of standards and controls in place in legislation and within our business.

However, for peace of mind our professional advice is covered through our Public Indemnity Insurance, which we hold to the value of £2m.



Why bdi?

It is no secret that there are thousands of Structural Engineers out there. If you don't already know us, why would you choose us over another practice? After all, we're all designing with the same materials and to the same codes of practice...so why choose BDI?

We truly believe in the service we provide and continuously strive to deliver quality. From instruction, each project is assigned a project engineer who is responsible for the delivery of the project and remains your key contact. We take a pro-active and responsive approach to our work by providing regular updates on our progress and remain within easy contact on the phone or by email.

To ensure a high level of quality, we have rigorous in-house checking procedures that ensure each calculation and drawing is materially checked by a second Engineer. The design package then undergoes a high-level design review by a Senior Engineer prior to being issued.

Our residential project services are offered with fixed fees and fixed timescales ensuring you know where you're at and you know where we're at!

Our commitment to quality and service was rewarded in 2014 when we were voted the 'Best Structural Engineering Company in the North West' by our clients.

BDI Structural Solutions
Crossford Court, Dane Road, Sale, Cheshire, M33 7BZ,

Telephone: 0161 969 3886
Email: info@bdistructuralsolutions.co.uk